

## Terminals Series

### KLS8-01102 Cross bare terminal Series

Terminal Material: COPPER

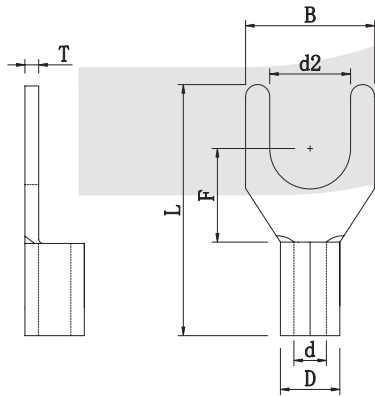

| Item No.     | Section of lead                                      | Dimension  |       |      |      |      |      |      |      |
|--------------|--|------------|-------|------|------|------|------|------|------|
|              |  | USA BOLTNO | d2 mm | B mm | L mm | F mm | H mm | D mm | d mm |
| SNB1.25~3    | 0.5~1.5mm <sup>2</sup><br>(22~16A.W.G.)<br>I Max=19A | #4         | 3.2mm | 5.7  | 16.0 | 6.5  | 4.8  | 3.4  | 1.7  |
| SNBS1.25-3.5 |  | #6         | 3.7mm | 5.7  | 16.0 | 6.5  |      |      |      |
| SNBL1.25-3.5 |  | #6         | 3.7mm | 6.4  | 16.0 | 6.5  |      |      |      |
| SNBS1.25-4   |  | #8         | 4.3mm | 6.4  | 16.0 | 6.5  |      |      |      |
| SNBM1.25-4   |  | #8         | 4.3mm | 7.2  | 16.0 | 6.5  |      |      |      |
| SNBL1.25-4   |  | #8         | 4.3mm | 8.1  | 16.0 | 6.5  |      |      |      |
| SNBS1.25-5   |  | #10        | 5.3mm | 8.1  | 16.0 | 6.5  |      |      |      |
| SNBL1.25-5   |  | #10        | 5.3mm | 9.5  | 16.0 | 6.5  |      |      |      |
| SNBS1.25-6   |  | 1/4        | 6.5mm | 9.5  | 16.0 | 6.5  |      |      |      |
| SNBL1.25-6   |  | 1/4        | 6.5mm | 12.0 | 22.0 | 11.0 |      |      |      |
| SNB2-3       | 1.5~2.5mm <sup>2</sup><br>(16~14A.W.G.)<br>I Max=27A | #4         | 3.2mm | 5.7  | 16.0 | 6.5  | 4.8  | 4.1  | 2.3  |
| SNBS2-3.5    |  | #6         | 3.7mm | 5.7  | 16.0 | 6.5  |      |      |      |
| SNBL2-3.5    |  | #6         | 3.7mm | 6.4  | 16.0 | 6.5  |      |      |      |
| SNBS2-4      |  | #8         | 4.3mm | 6.4  | 16.0 | 6.5  |      |      |      |
| SNBM2-4      |  | #8         | 4.3mm | 7.2  | 16.0 | 6.5  |      |      |      |
| SNBL2-4      |  | #8         | 4.3mm | 8.1  | 16.0 | 6.5  |      |      |      |
| SNBS2-5      |  | #10        | 5.3mm | 8.1  | 16.0 | 6.5  |      |      |      |
| SNBL2-5      |  | #10        | 5.3mm | 9.5  | 16.0 | 6.5  |      |      |      |
| SNBS2-6      |  | 1/4        | 6.5mm | 9.5  | 16.0 | 6.5  |      |      |      |
| SNBL2-6      |  | 1/4        | 6.5mm | 12.0 | 22.0 | 11.0 |      |      |      |

## ORDER INFORMATION

KLS8-01102 - SNB1.25~3

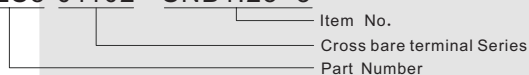

## Terminals Series

### KLS8-01102 Cross bare terminal Series

VIII

| Item No.   | Section of lead                                    | Dimension  |          |         |         |         |         |         |         |
|------------|--|------------|----------|---------|---------|---------|---------|---------|---------|
|            |  | USA BOLTNO | d2<br>mm | B<br>mm | L<br>mm | F<br>mm | H<br>mm | D<br>mm | d<br>mm |
| SNB3.5-4   | 2.5~4mm <sup>2</sup><br>(14~12A.W.G.)<br>I Max=37A | #8         | 4.3mm    | 8.0     | 18.3    | 7.0     | 6.0     | 5.0     | 3.0     |
| SNB3.5-5   |  | #10        | 5.3mm    | 8.0     | 18.3    | 7.0     |         |         |         |
| SNB3.5-6   |  | 1/4        | 6.5mm    | 12.0    | 21.5    | 12.1    |         |         |         |
| SNB5.5-3.5 | 4~6mm <sup>2</sup><br>(12~10A.W.G.)<br>I Max=48A   | #6         | 3.7mm    | 8.3     | 19.5    | 7.5     | 6.8     | 5.6     | 3.4     |
| SNBS5.5-4  |  | #8         | 4.3mm    | 8.3     | 19.5    | 7.5     |         |         |         |
| SNBL5.5-4  |  | #8         | 4.3mm    | 9.0     | 18.2    | 7.5     |         |         |         |
| SNB5.5-5   |  | #10        | 5.3mm    | 9.0     | 18.2    | 7.5     |         |         |         |
| SNBS5.5-6  |  | 1/4        | 6.5mm    | 9.0     | 18.2    | 7.5     |         |         |         |
| SNBL5.5-6  |  | 1/4        | 6.5mm    | 12.0    | 25.5    | 12.0    |         |         |         |
| SNB5.5-8   |  | 5/16       | 8.4mm    | 14.0    | 24.5    | 11.5    |         |         |         |

## ORDER INFORMATION

KLS8-01102 - SNB1.25~3

Item No.  
 Cross bare terminal Series  
 Part Number