

## SMD COMMON MODE TOROIDS COILS / SFT TYPE

### FEATURES

- ◆ Reduced components height
- ◆ High rated currents
- ◆ Suitable for reflow soldering
- ◆ RoHS-compatible



### APPLICATIONS

- ◆ Automotive applications
- ◆ Industrial applications
- ◆ Telecom applications

### ORDERING CODE

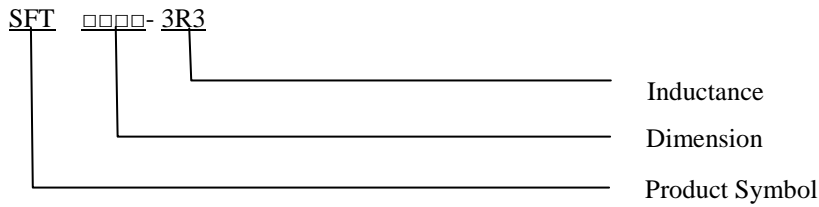

### SHAPES

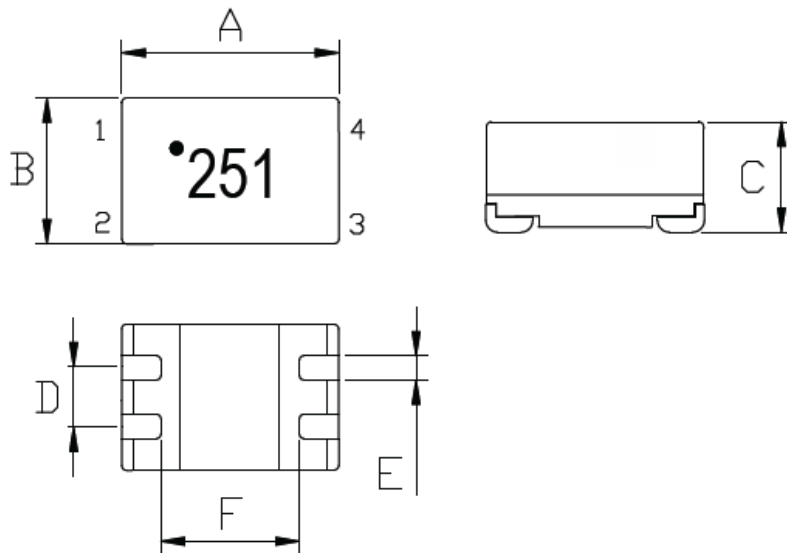

### DIMENSIONS (UNIT: mm)

Part No.	A	B	C	D	E	F
<b>SFT0905</b>	9.2 ± 0.3	6.0 ± 0.3	5.0 ± 0.3	2.54 ± 0.3	1.0 (REF)	5.7 (REF)



**CORE MASTER ENTERPRISE CO., LTD.**

<http://www.coremaster.com.tw>

## SMD COMMON MODE TOROIDS COILS / SFT TYPE

### ELECTRICAL CHARACTERISTICS FOR SFT0905

Part No.	Inductance ( $\mu$ H)	Test Frequency (KHz)	RDC ( $m\Omega$ ) MAX	IDC (A) MAX
SFT0905-100□	10 +50% / -30%	1KHz / 0.1V	80	1.6
SFT0905-250□	25 $\pm$ 30%	1KHz / 0.1V	120	1.3
SFT0905-400□	40 $\pm$ 30%	1KHz / 0.1V	120	1.3
SFT0905-510□	51 $\pm$ 30%	1KHz / 0.1V	120	1.3
SFT0905-251□	250 $\pm$ 50%	100KHz / 0.05V	130	1.2
SFT0905-501□	500 $\pm$ 50%	100KHz / 0.05V	150	1.0
SFT0905-102□	1000 $\pm$ 50%	100KHz / 0.05V	310	0.8
SFT0905-202□	2000 $\pm$ 50%	100KHz / 0.05V	420	0.6
SFT0905-472□	4700 $\pm$ 50%	100KHz / 0.05V	900	0.4
SFT0905-652□	6500 $\pm$ 50%	100KHz / 0.05V	1050	0.3



CORE MASTER ENTERPRISE CO., LTD.

<http://www.coremaster.com.tw>